

## CompoSe 600L90

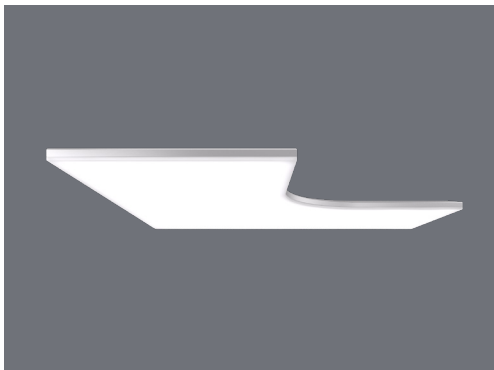

CompoSe 600L90 - 90 degree, L shaped LED based modular intelligent luminaire. Intended for use as a module in a CompoSe 600 array, or as an individual luminaire when fully framed. Direct and Direct/Indirect light distribution options: '1Way' and '2Way'. 'Frameless' panel design with a 'floating' 8mm Satin high-grade acrylic diffuser panel.

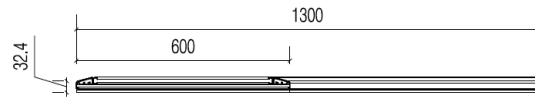

Side Elevation

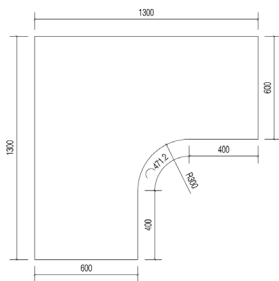

Front Elevation

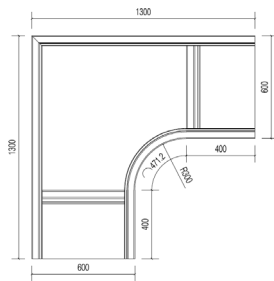

Rear Elevation - open ends - OO

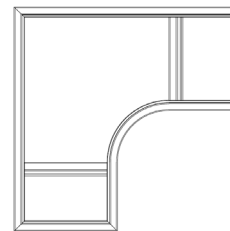

Rear Elevation - one end framed - FO

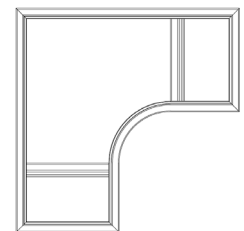

Rear Elevation - fully framed - FF

## Applications

Ceiling suspended as part of a CompoSe 600 ceiling feature  
 Ceiling suspended as an individual luminaire

Wall mounted as part of a CompoSe 600 wall feature  
 Wall mounted as an individual luminaire

## Size Options

CompoSe 600 L90 - 600mm wide x 32mm visible edge. Standard dimensions as per drawing. Custom panel sizes to minimise joints can be manufactured on a project-to-project basis - maximum overall module size must fit within a 1200x2400mm rectangle. CompoSe L90 is also available in 300 and 450mm widths. Custom widths up to 600mm - on request.

## LED Options

**CCT Standard White** - 2700K, 3000K, 4000K, 5000K, 6500K / **Tunable White** - 2200K to 6500K / **RGB** - fully dynamic.  
 CRI 80 / CRI 90 optional for 2700K, 3000K, 4000K

## Light Performance

### '1Way'

Result: Light distribution curve [cd]

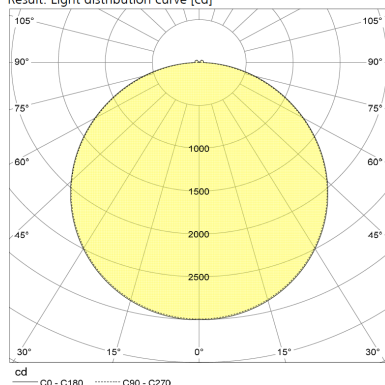

CompoSe 600L90		Luminaire	
CCT		Flux	Efficacy
White	2700K	15.082lm	73lm/W
	3000K	15.939lm	77lm/W
	4000K	17.139lm	83lm/W
	5000K	17.139lm	83lm/W
	6500K	17.139lm	83lm/W
Tunable White	2200-6500K	12.327lm	73lm/W

Tunable White: normalised output  
 CRI: 80. CRI 90 optional for 2700K, 3000K, 4000K  
 Luminaire input power: 208W for white, 170W for TW  
 Standby power: 0.5 W  
 Rated median useful life: 50000h L80 at 25C  
 Colour tolerance: MacAdam 3

## '2Way'

Result: Light distribution curve [cd]

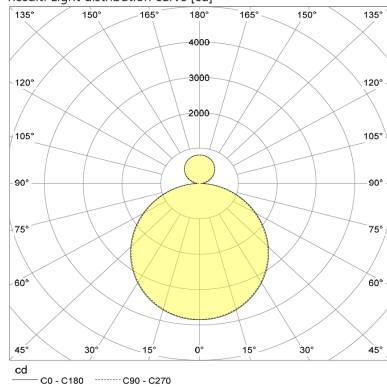

CompoSe 600L90		Luminair	
CCT		Flux	Efficacy
White	2700 K	14.554lm	70lm/W
	3000K	15.381lm	74lm/W
	4000K	16.539lm	80lm/W
	5000K	16.539lm	80lm/W
	6500K	16.539lm	80lm/W
Tuneable White	2200-6500K	11.896lm	70lm/W

Tuneable White: normalised output  
CRI: 80. CRI 90 optional for 2700K, 3000K, 4000K  
Luminair input power: 208W for white, 170W for TW  
Standby power: 0,5 W  
Rated median useful life: 50000h L80 at 25C  
Colour tolerance: MacAdam 3

## Design Options

Standard front panel design - 8mm Satin high-grade acrylic diffuser panel.

Design Options: **Printed** - Custom print design, digitally applied to individual panels or over multiple panels  
**Etched** - Custom etch design, digitally laser-etched on individual panels or over multiple panels. This option shows an 8mm visible frame.

## Control

Individually Intelligent Panel - integrated DALI LED driver (type DT6 or DT8) for calibration, dimming and colour control. Electronic Panel Connector to feed and control up to 5 lm. CompoSe panels with only 1 Power/DALI cable. Full range of fixed and wireless panel control options. Panels can be controlled individually, in groups or multiple groups. Remote programming and monitoring. Supports DALI daylight, motion sensors etc.

## Properties

'Frameless' panel design as a result of a proprietary 'diffuser-to-frame' fixing system. Liquid Nitrogen extruded, high quality aluminium profiles, for best possible natural anodised finish. Flat luminair with 32mm visible edge. Frameless panel ends with connectors where panels connect in a CompoSe array, to ensure optimised panel joint experience. High-grade 8mm Satin PMMA (acrylic) diffuser for optimised light distribution and glare control. 48V LED system with integrated DALI LED driver, Electronic Panel Connector and a connected decorative 5-core power lead. Ceiling Suspended with a 1,5mm dia wire suspension system or Wall Mount with proprietary wall bracket system.