

MorPh

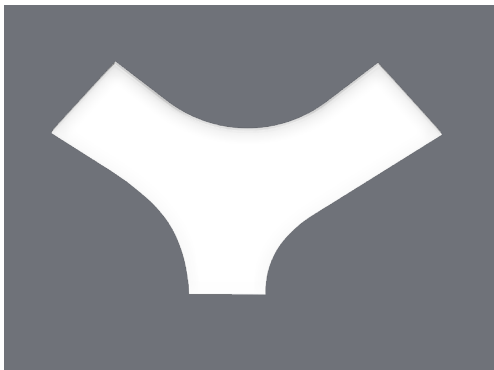

MorPh - an asymmetrical Y-shaped LED based intelligent luminaire. Intended for use as part of a connected arrangement. Intelligent panel shape with 3 different radii which can be connected in multiple ways to form an infinite number of lighting designs. Direct (1Way) and Direct/Indirect (2Way) light emission options. 'Frameless' panel design with a 'floating' 8mm Satin high-grade acrylic diffuser panel.

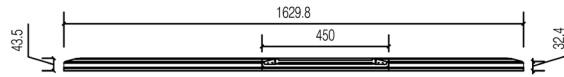

Side Elevation

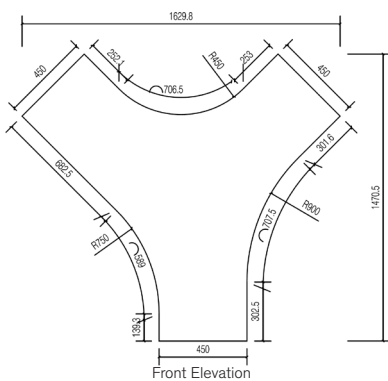

Front Elevation

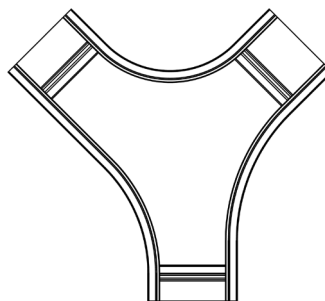

Rear Elevation - OOO

If MorPh is used as an end unit, individual panel ends can be framed.

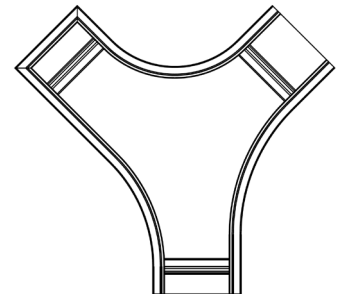

Rear Elevation - FOO

Applications

Ceiling suspended as part of a MorPh ceiling feature

Wall mounted as part of a MorPh wall feature

Cross-over - ceiling/wall installation connecting wall panels with ceiling panels using a CompoSe 450 CVI panel

Size Options

MorPh - standard size x 32mm visible edge - see drawing.

LED Options

CCT Standard White - 2700K, 3000K, 4000K, 5000K, 6500K / **Tunable White** - 2200K to 6500K / **RGB** - fully dynamic.
CRI 80 / CRI 90 optional for 2700K, 3000K, 4000K

Light Performance

'1Way'

Result: Light distribution curve [cd]

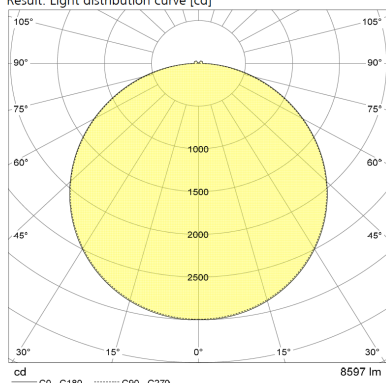

MorPh	Flux Luminair					
CCT	2700K	3000K	4000K	5000K	6500K	TW 2200-6500K
MorPh	14.729lm	15.566lm	16.738lm	16.738lm	16.738lm	12.039lm

Tunable White: normalised output
CRI: 80, CRI 90 optional for 2700K, 3000K, 4000K
Luminair input power: 175W for Single Whites, 151W for Tuneable White
Standby power: 0.5 W
Rated median useful life: 50000h L80 at 25C
Colour tolerance: MacAdam 3

'2Way'

Result: Light distribution curve [cd]

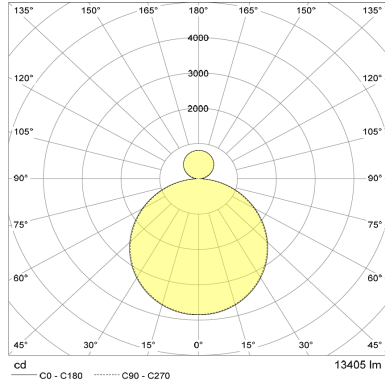

MorPh		Flux Luminair				
CCT	2700K	3000K	4000K	5000K	6500K	TW 2200-6500K
MorPh	14.214lm	15.022lm	16.152lm	16.152lm	16.152lm	11.618lm

Tuneable White: normalised output
CRI: 80. CRI 90 optional for 2700K, 3000K, 4000K
Luminair input power: 175W for Single Whites, 151W for Tuneable White
Standby power: 0,5 W
Rated median useful life: 50000h L80 at 25C
Colour tolerance: MacAdam 3

Design Options

Standard front panel design - 8mm Satin high-grade acrylic diffuser panel.

Design Option: **Printed** - Custom print design, digitally applied to individual panels or over multiple panels

Control

Individually Intelligent Panel - integrated DALI LED driver (type DT6, DT8 - 3 channel) for dimming and colour control. Integrated driver ensures flicker free light. Electronic Panel Connector to feed and control up to 3 connected panels with one cable. Full range of fixed and wireless panel control options. Panels can be controlled individually, in groups or multiple groups. Supports DALI daylight, motion sensors etc.

Properties

'Frameless' panel design as a result of a proprietary 'diffuser-to-frame' fixing system. Liquid Nitrogen extruded, high quality aluminium profiles, for best possible natural anodised finish. Flat luminair with 32mm visible edge. Frameless panel ends with connectors where panels connect in a MorPh array, to ensure optimised panel joint experience. High-grade 8mm Satin PMMA (acrylic) diffuser for optimised light distribution and glare control. 48V LED system with integrated DALI LED driver, Electronic Panel Connector and a connected decorative 4-core power lead. Ceiling Suspended with a 1,5mm dia wire suspension system or Wall Mount with proprietary wall bracket system.
