

## MorPh

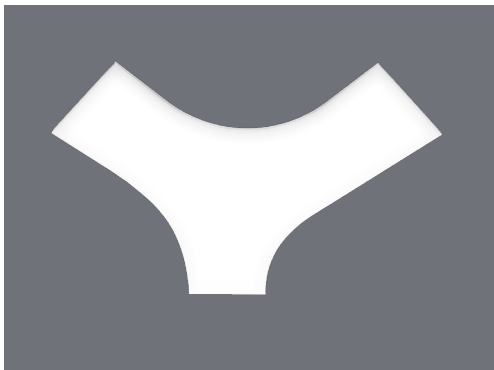

MorPh - an asymmetrical Y-shaped LED based intelligent luminaire. Intended for use as part of a connected arrangement. Intelligent panel shape with 3 different radii which can be connected in multiple ways to form an infinite number of lighting designs. Direct (1Way) and Direct/Indirect (2Way) light emission options. 'Frameless' panel design with a 'floating' 8mm Satin high-grade acrylic diffuser panel.

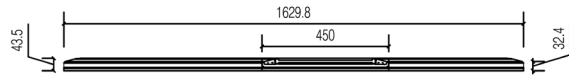

Side Elevation

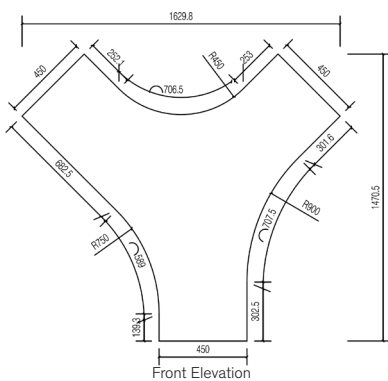

Front Elevation

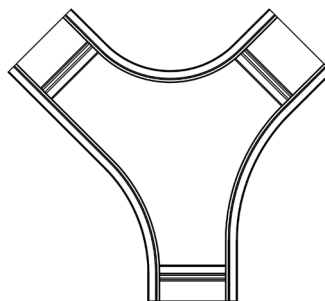

Rear Elevation - OOO

If MorPh is used as an end unit, individual panel ends can be framed.

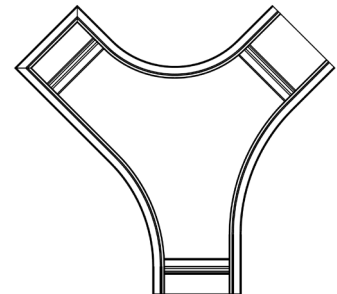

Rear Elevation - FOO

## Applications

Ceiling suspended as part of a MorPh ceiling feature

Wall mounted as part of a MorPh wall feature

Cross-over - ceiling/wall installation connecting wall panels with ceiling panels using a CompoSe 450 CVI panel

## Size Options

MorPh - standard size x 32mm visible edge - see drawing.

## LED Options

**CCT Standard White** - 2700K, 3000K, 4000K, 5000K, 6500K / **Tunable White** - 2200K to 6500K / **RGB** - fully dynamic.  
CRI 80 / CRI 90 optional for 2700K, 3000K, 4000K

## Light Performance

### '1Way'

Result: Light distribution curve [cd]

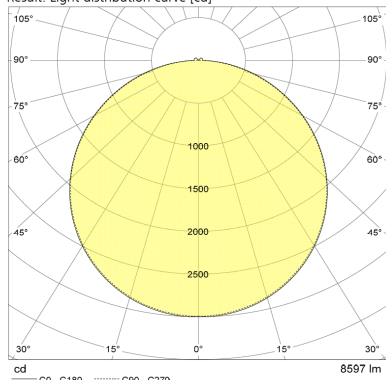

MorPh	Flux Luminair					
CCT	2700K	3000K	4000K	5000K	6500K	TW 2200-6500K
MorPh	14.729lm	15.566lm	16.738lm	16.738lm	16.738lm	12.039lm

Tunable White: normalised output  
CRI: 80, CRI 90 optional for 2700K, 3000K, 4000K  
Luminair input power: 175W for Single Whites, 151W for Tuneable White  
Standby power: 0,5 W  
Rated median useful life: 100.000h L80 at 25C  
Colour tolerance: MacAdam 3

## '2Way'

Result: Light distribution curve [cd]

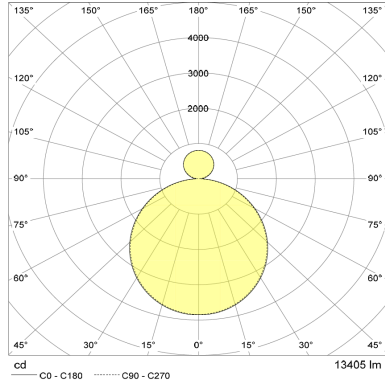

MorPh		Flux Luminair				
CCT	2700K	3000K	4000K	5000K	6500K	TW 2200-6500K
MorPh	14.214lm	15.022lm	16.152lm	16.152lm	16.152lm	11.618lm

Tuneable White: normalised output  
CRI: 80. CRI 90 optional for 2700K, 3000K, 4000K  
Luminair input power: 175W for Single Whites, 151W for Tuneable White  
Standby power: 0,5 W  
Rated median useful life: 100.000h L80 at 25C  
Colour tolerance: MacAdam 3

## Design Options

Standard front panel design - 8mm Satin high-grade acrylic diffuser panel.

Design Option: **Printed** - Custom print design, digitally applied to individual panels or over multiple panels

## Control

Individually Intelligent Panel - integrated DALI LED driver (type DT6, DT8 - 3 channel) for dimming and colour control. Integrated driver ensures flicker free light. Electronic Panel Connector to feed and control up to 3 connected panels with one cable. Full range of fixed and wireless panel control options. Panels can be controlled individually, in groups or multiple groups. Supports DALI daylight, motion sensors etc.

## Properties

'Frameless' panel design as a result of a proprietary 'diffuser-to-frame' fixing system. Liquid Nitrogen extruded, high quality aluminium profiles, for best possible natural anodised finish. Flat luminair with 32mm visible edge. Frameless panel ends with connectors where panels connect in a MorPh array, to ensure optimised panel joint experience. High-grade 8mm Satin PMMA (acrylic) diffuser for optimised light distribution and glare control. 48V LED system with integrated DALI LED driver, Electronic Panel Connector and a connected decorative 4-core power lead. Ceiling Suspended with a 1,5mm dia wire suspension system or Wall Mount with proprietary wall bracket system.